



4EB

Series 4EB Electromagnetic Single-Face Brakes



Stationary Field for Dry Operation

Series 4EB electromagnetic stationary field single-face brakes are zero backlash and designed for dry use. When the coil is energized by a DC voltage, a magnetic field is generated which attracts the armature disc to the magnet assembly. The armature disc is connected to a rotating member in the drive by a diaphragm spring. Various brake configurations are available to suit different drive installation requirements.

Features

- Zero backlash for accurate positioning
- Long life asbestos-free friction material
- Simple supply connection facilitates installation
- Zero drag torque when disengaged
- Efficient magnet design reduces power consumption and heat generation
- Can be used as a continuously slipping variable torque device for torque limiting and tensioning applications
- Ideal for high cyclic and other brake duties

Typical Applications

- Rapid Start / Stop Machines
- Lifting, Slewing and Traveling Motions with Handling Devices
- Feed Drives on Machine Tools
- Forklift Trucks
- Label Printing Machines

For Technical Assistance Call

800-825-9050

 **Matrix**[®]
International
An Altra Industrial Motion Company



S.I.T., S.A. | Tfno. 943 457200 | Fax 943 463356 | www.sitsa.es | atencioncliente@sitsa.es

MODEL		4EB 025	4EB 040	4EB 050	4EB 060	4EB 100
Performance Data						
Rated Static Torque	Nm	11	45	72	150	750
	ft-lbs	8	33	53	111	553
Rated Dynamic Torque	Nm	9	37	59	120	500
	ft-lbs	7	27	44	89	369
Power Consumption at 20° C	Watts	12	21	31	40	57.5
Maximum Speed	rev/min	7500	4400	4000	3000	2000

Dimensional Data (all dimensions in mm)						
Bore Coupling Mount	Maximum	32	49	53	55	96
	Minimum	10	15	19	25	40

Diameters (all dimensions in mm)						
A		72.5	115.5	135.5	160	250
B (f7)		87	140	160	190	290
C		41	71	83	80	125
D		66	107	127	160	250
E (H7)		47	80	95	80	125
F		41	71	83	80	125

Lengths						
L		29,5	37,0	40,5	29,3	35,0
M (ref)		36,2	44,0	48,0	41,0	59,0
N (Air Gap Setting)		0,2/0,3	0,2/0,3	0,2/0,3	0,35/0,45	0,45/0,55
P (ref)		60,5	78,0	86,5	86,5	105,5
Q		18,2	24,2	26,5	30,0	46,5
R		24,25	34,25	38,50	45,0	55,0
S (ref)		42,2	54,0	60,0	53,5	58,9

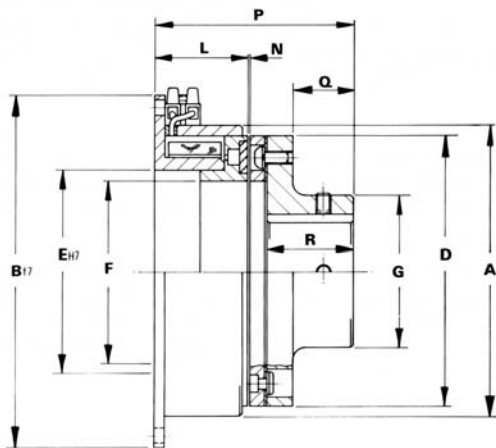

Style C

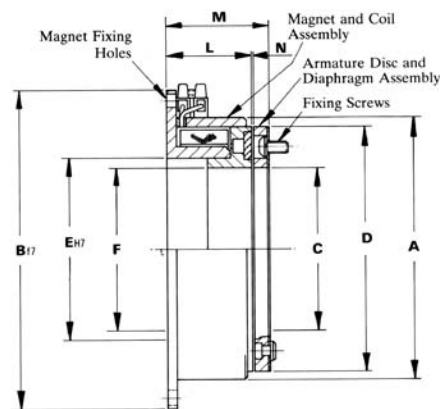

Style D



Matrix International
 449 Gardner St. • South Beloit, IL 61080
 815-389-6274 • Fax: 815-389-2582
 E-mail: matrix.usa@altramotion.com
 www.matrix-international.com

P-1788-11-MX 5/09 Printed in USA

